

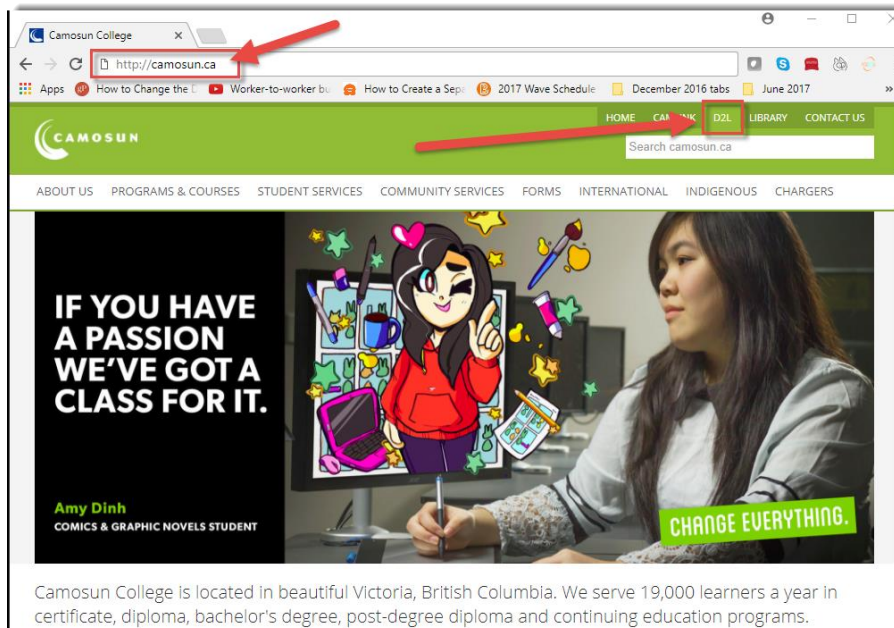

## Logging into D2L – a Student Tutorial

1. Open an Internet browser and go to the Camosun College website (<http://camosun.ca>). We recommend you use Chrome as your Internet browser if possible. Then click **D2L** in the top, right-hand corner of the site.



2. Type in your Camosun ID number (your C#) and the Password you use with your C# to log into college computers. Then click **Log in**.

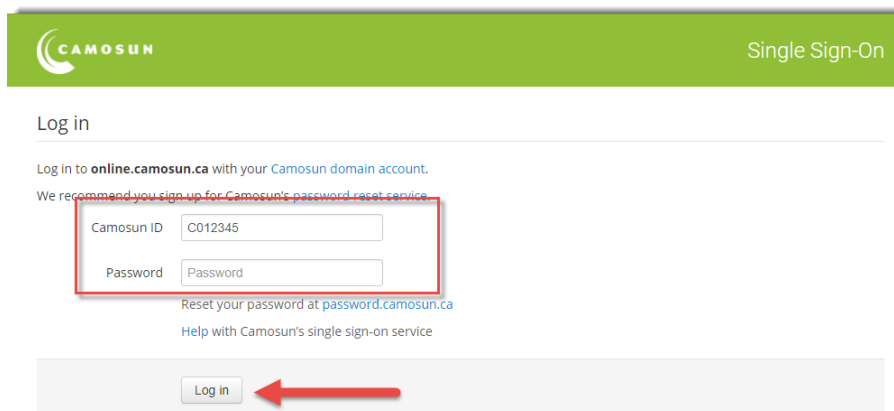

**NOTE:** IF you do not have a password for your C# yet, or if you have forgotten your password, you will have to go to <http://password.camosun.ca>, login, and click **Forgot Password**. If you are unable to reset your password, contact [helpdesk@camosun.ca](mailto:helpdesk@camosun.ca) for assistance.



- Once you have logged into D2L, you will see the courses you have access to listed in the My Courses box on the homepage. Click on the title of the course you wish to access to go to it. *Note that you will NOT be able to access your D2L course site until the start date of the course.*

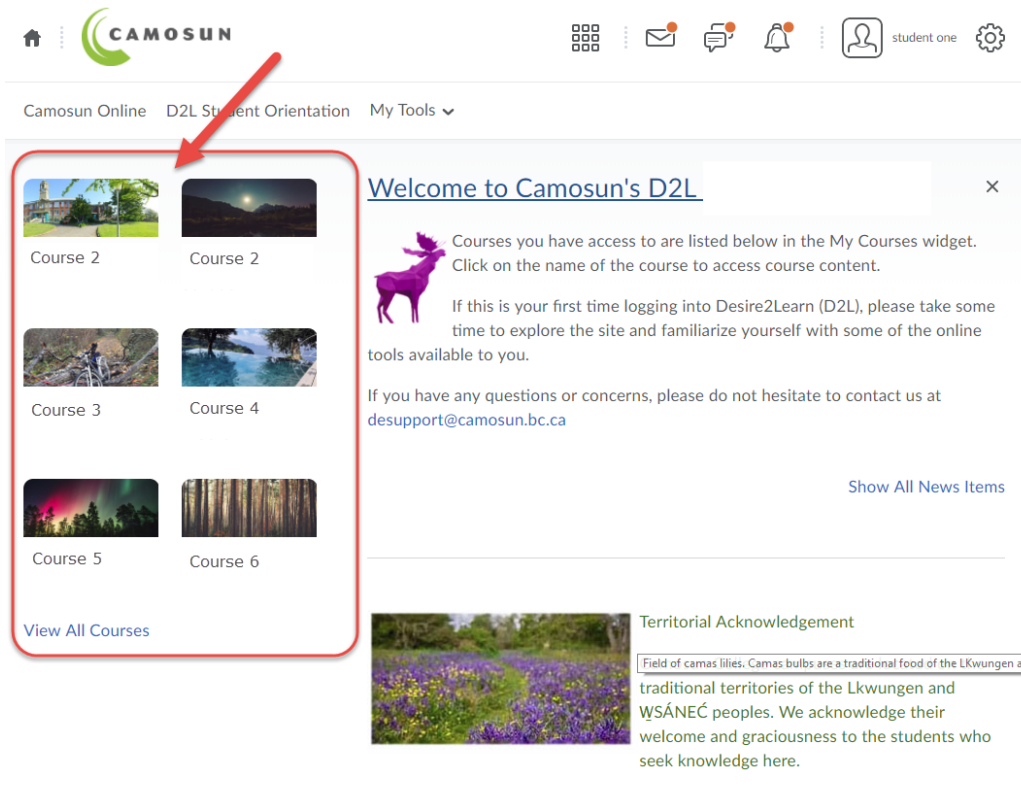

Once you go into your course site, you may wonder where you will find your course content. This will vary from course to course, depending on your instructors. Some places to look include:

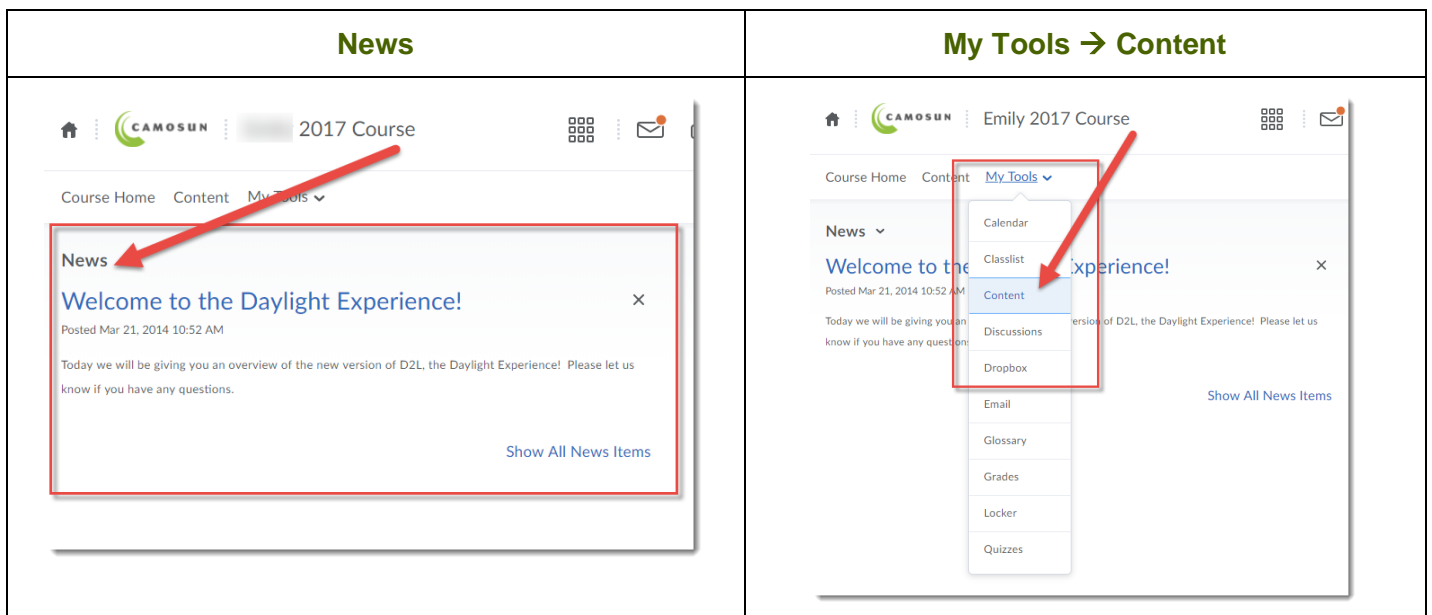

If you still don't know where to find your course materials, talk to your instructor!

Finally, if you have technical issues with D2L during the term, contact [elearning@camosun.ca](mailto:elearning@camosun.ca) for assistance.



This content is licensed under a [Creative Commons Attribution 4.0 International Licence](https://creativecommons.org/licenses/by/4.0/). Icons by the [Noun](https://nounsproject.com/) Project.